

WCCUSD
Bond Program Project Status Report

School Type	#	Sub-Project Name	Architect of Record	Construction Contract Value	Notice to Proceed	Completion Date	Measure	Percent Complete	Change Orders		Pending Change Orders		Notice of Completion
									Amount	%	Amount	%	
Elementary Schools	1	Coronado Elementary School Campus Replacement	WLC Architects	\$26,974,910	1/6/14	7/7/15	D-2010	99%	\$1,122,957.00	4.16%	\$41,323.00	0.15%	
	2	Nystrom Elementary School Modernization	Interactive Resources	\$21,188,102	8/25/14	12/18/15	J	83%	\$452,544.00	2.14%	\$0.00	0.00%	
	3	Valley View Elementary School Interim Housing	DLM Architects	\$3,466,000	4/1/15	11/13/15	D-2010	85%	\$44,310.00	1.28%	\$8,720.52	0.25%	
	4	Dover Elementary School Synthetic Playfield	HY Architects	\$480,357	7/7/15	12/4/15	E-2012	57%	\$0.00	0.00%	\$0.00	0.00%	
	5	Lincoln Elementary School Bldg 'A' Ext Repairs	GDG	\$352,000	7/14/15	10/12/15	E-2012	50%	\$0.00	0.00%	\$0.00	0.00%	
	6	Ohlone Elementary School Parking & Landscape Completion	Powell & Partners	\$239,950.00	7/29/2015	9/7/2015	J	82%	\$0.00	0.00%	\$0.00	0.00%	
Middle Schools	7	Fred T. Korematsu Middle School Campus Replacement	HY Architects	\$42,762,406	5/13/13	12/29/15	J	92%	\$1,030,057.58	2.41%	\$143,288.82	0.34%	
High Schools	8	Sylvester Greenwood Academy / LPS Campus Replacement	HMC Architects	\$53,887,350	8/20/12	7/31/15	D-2010	99%	\$3,277,361.00	6.08%	\$84,162.00	0.16%	
	9	De Anza High School: Linked Learning Building & Athletic Fields	DLM Architects	\$17,750,953	10/13/14	11/12/15	J	88%	\$439,263.00	2.47%	-\$32,438.00	-0.18%	
	10	El Cerrito High School Stadium	WLC Architects	\$13,438,000	1/27/14	9/27/15	D-2010	87%	\$506,030.00	3.77%	\$47,243.00	0.35%	
	11	Kennedy High School Richmond Swim Center	Architects MA	\$7,642,921	4/28/14	6/4/15	J	97%	\$495,114.72	6.48%	\$0.00	0.00%	
	12	Pinole Valley High School Existing Campus Demolition	WLC Architects	\$1,823,500	2/16/15	8/15/15	D-2010	99%	\$145,884.10	8.00%	-\$20,214.80	-1.11%	
	13	Pinole Valley High School Hillside Stabilization Inc 1 & 2	WLC Architects	\$1,722,600	9/29/14	9/24/15	D-2010	98%	\$5,052.95	0.29%	-\$4,701.87	-0.27%	
	14	Kennedy High School Fabrication Laboratory	DLM Architects	\$893,000	4/8/15	6/16/15	E-2012	99%	\$12,548.15	1.41%	\$770.14	0.09%	10/21/2015
TOTALS									\$7,531,122.50	3.91%	\$268,152.81	0.14%	

* = Project will no longer be reported
(All Change Orders are BOE approved; NOC has been filed)

Citizen's Bond Oversight Committee
as of 10/22/15

WCCUSD Bond Program Project Status Report



Citizen Bond Oversight Committee
Measure M, D, J, D-2010 & E-2012

October 28, 2015

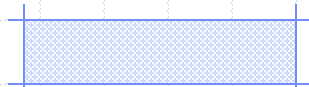

Elementary Schools





**1.a. Coronado Elementary School
Administration Office Entrance**



2.a. Nystrom Elementary School
North Building



2.b. Nystrom Elementary School



2.c. Nystrom Elementary School



**2.e. Nystrom Elementary School
Kindergarten Room**



**2.f. Nystrom Elementary School
IDF Room**



**3.c. Valley View Elementary School
Interim Campus**



3.d. Valley View Elementary School Interim Campus



3.e. Valley View Elementary School Interim Campus



**3.f. Valley View Elementary School
Interim Campus**



**3.g. Valley View Elementary School
Interim Campus
Kindergarten Play Structure**



3.h. Valley View Elementary School Interim Campus – Play Structure



**4.a. Dover Elementary School
Synthetic Playfield**



**4.b. Dover Elementary School
Synthetic Playfield**



4.c. Dover Elementary School
Synthetic Playfield



**4.d. Dover Elementary School
Synthetic Playfield**



4.e. Dover Elementary School
Synthetic Playfield



**5.a. Lincoln Elementary School
Building 'A' Exterior Repairs**



5.b. Lincoln Elementary School Building 'A' Exterior Repairs



5.c. Lincoln Elementary School
Building 'A' Exterior Repairs



**6.a. Ohlone Elementary School
Parking & Landscaping**



**6.b. Ohlone Elementary School
Parking & Landscaping**

Middle Schools





7.b. Fred T. Korematsu Middle School Quad – Landscaping Elements



7.c. Fred T. Korematsu Middle School
Building 'A'



7.d. Fred T. Korematsu Middle School



7.e. Fred T. Korematsu Middle School
Multipurpose Building



7.f. Fred T. Korematsu Middle School Building 'A' East View on Donal Ave.



**7.g. Fred T. Korematsu Middle School
Sidewalk Concrete Pour – Donal Ave.**



**7.h. Fred T. Korematsu Middle School
Building 'A' Linoleum Installation**



**7.i. Fred T. Korematsu Middle School
Bldg 'D' Music Room Acoustical Panel**



7.I. Fred T. Korematsu Middle School
Gymnasium & Trenching

High Schools





**8.a. Sylvester Greenwood Academy &
Leadership Public School
LPS – Entrance**

PARKING RATIO CALCULATIONS		
LOT #	TOTAL NUMBER OF STALLS	ACCESSIBLE PARKING STALLS
1	65	3
2	52	3
3	89	4 (PROVIDED IN LOT #2)

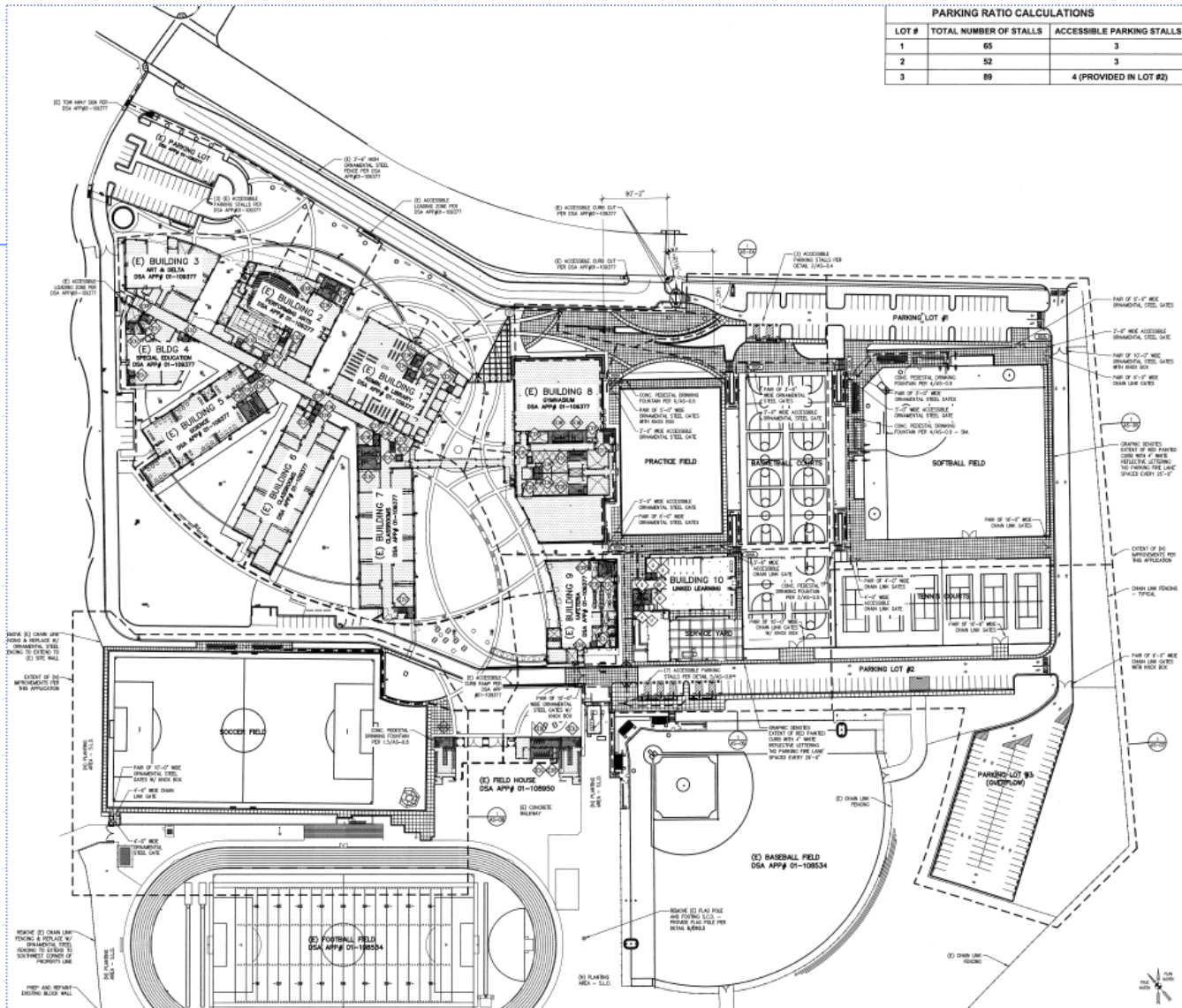

9.a. De Anza High School Linked Learning Building & Athletic Fields



**9.b. De Anza High School
Linked Learning Building & Athletic Fields
Marquee**



**9.c. De Anza High School
Linked Learning Building & Athletic Fields
Basketball Courts**



9.e. De Anza High School
Linked Learning Building & Athletic Fields
Basketball Courts - Coating



**9.f. De Anza High School
Linked Learning Building & Athletic Fields
Softball Field**



**9.g. De Anza High School
Linked Learning Building & Athletic Fields
Tennis Courts**



**9.h. De Anza High School
Linked Learning Building & Athletic Fields
Soccer Field**



**9.i. De Anza High School
Linked Learning Building & Athletic Fields
Flat Work**



**9.j. De Anza High School
Linked Learning Building & Athletic Fields
Terrazzo Floor Installation**



**10.a. El Cerrito High School Stadium
Project Site**



**10.b. El Cerrito High School Stadium
Bleachers**



**10.c. El Cerrito High School Stadium
Bleachers**



10.d. El Cerrito High School Stadium



**10.e. El Cerrito High School Stadium
Track Surfacing**



10.f. El Cerrito High School Stadium Concession



11.a. Kennedy High School
Richmond Swim Center



13.a. Pinole Valley High School
Demolition of Existing



**13.b. Pinole Valley High School
Hillside Stabilization**



**13.c. Pinole Valley High School
Hillside Stabilization**



**14.a. Kennedy High School
Digital Fabrication Laboratory
Printing Room**

Thank
You